

# MUD FLAP SYSTEM MESH INSERT 33.5" (850mm)

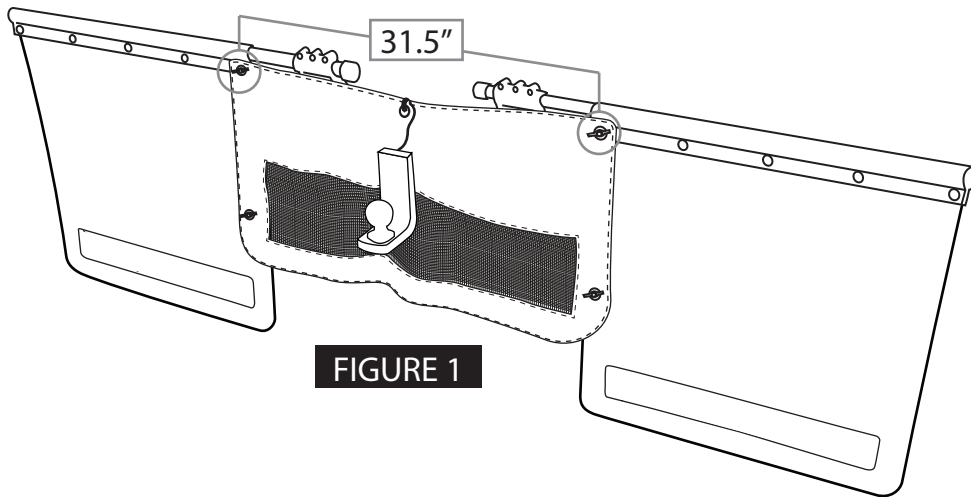

FIGURE 1

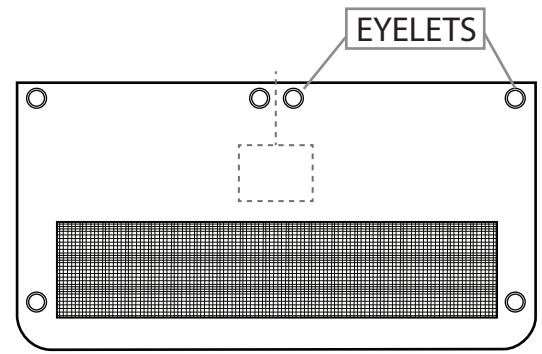

FIGURE 2

## INSTALLATION INSTRUCTIONS FOR MESH INSERTS 33.5" (850mm)

1. Set width of rubber flaps to approximately 31.5" between the first Flap Clamp Bolts on each side (see Figure 1)
2. Remove the 2 Flap Clamp Bolts, replace them with 2 included bolts with thread facing away from vehicle.  
Lock bolts into position using a nut (see Figure 3)
3. Place the Mesh Insert on these bolts, mark the location of the hole and slot that will be cut for the ball-mount on the Mesh Insert
4. With the Mesh Insert still in place, mark the location of the lower 2 eyelets on the rubber flaps
5. Place the mesh insert on a scrap piece of wood and cut the hole and slot using a sharp blade (see dotted line in Figure 2)
- \*NOTE THAT THE SLOT SHOULD BE CUT BETWEEN THE 2 TOP CENTER EYELETS\*
6. Drill 1/4" holes in the rubber flaps, corresponding with the markings from the lower eyelets
7. Insert a bolt, with 1 large washer, into the hole in the rubber flap with the thread facing away from the vehicle
8. Place another large washer over the lower bolt, then lock the bolt into position using a nut (see Figure 4)
9. Repeat steps 7 & 8 on other rubber flap
10. Place the Mesh Insert over the 4 bolts and secure in place using 4 small washers, 4 split lock washers and 4 wing nuts
11. Lace the 2 top center eyelets together using zip tie or string (not included)

NOTE: • Additional access slots can be cut for power leads, chains, etc.

- The Mesh Insert is a disposable item
- The life of the Mesh Insert will vary, depending on road conditions and speed
- A loose-fitting mesh will last longer than a tight-fitting mesh

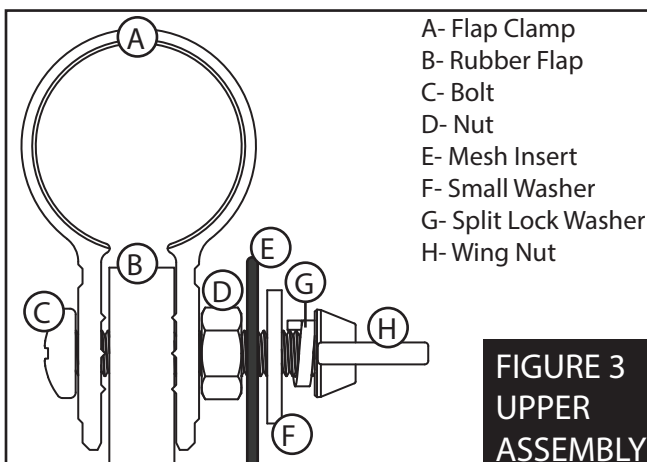

FIGURE 3  
UPPER  
ASSEMBLY

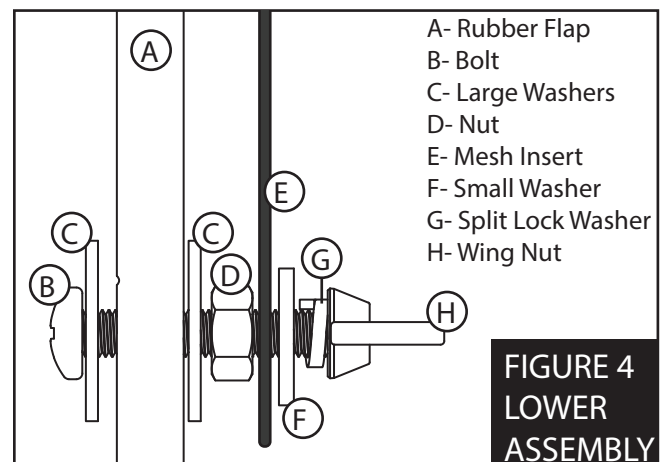

FIGURE 4  
LOWER  
ASSEMBLY