

Assembly Instructions

Account for all parts listed in the Parts List.

1. Slide HUB ASSEMBLY onto BALL MOUNT and insert into vehicle RECEIVER HITCH. *See Figures 2 & 3.*

2. Secure the BALL MOUNT with HITCH PIN. Adjust HUB ASSEMBLY to desired position.

3. Tighten the two M10 BALL MOUNT CLAMP BOLTS to hold CENTER HUB in place. (For assembly only) *See Figure 3.*

4. Loosen or Remove all three M6 ARM CLAMP BOLTS from each HUB ARM. Carefully insert the two FLAP SUPPORT RODS thru HUB ARMS. Place ROD END CAP over the end of rods, hex side facing away from vehicle, insert END CAP BOLT thru END CAP BOLT HOLE, tighten securely with M5 NYLON INSERT HEX NUT. *See Figure 4.*

Figure 2

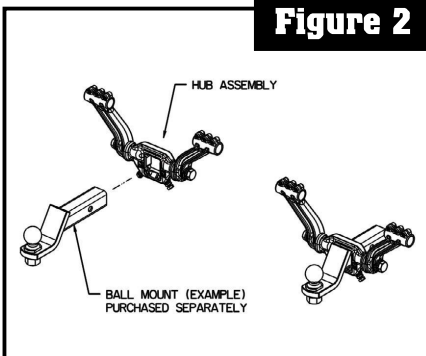

Figure 3

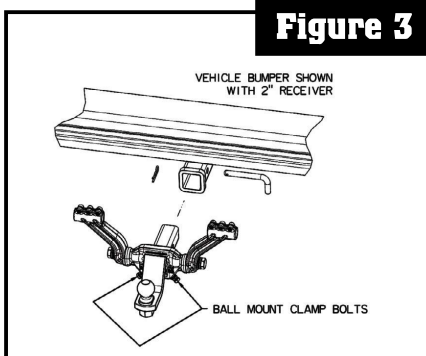
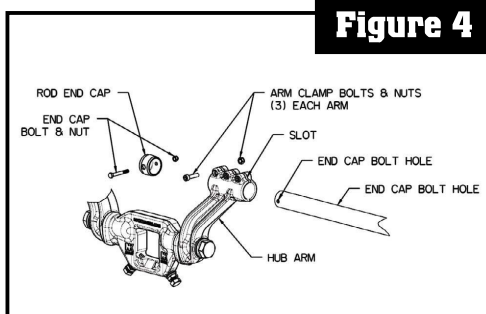

Figure 4



5

5. Re-install M6 ARM CLAMP BOLTS and M6 NYLON INSERT HEX NUTS back into HUB ARMS after the SUPPORT ROD is inserted. (Do not tighten yet.)
6. Position the left and right FLAP SUPPORT RODS so the width adjustment holes face forward horizontally. *Figure 5.*

Figure 5

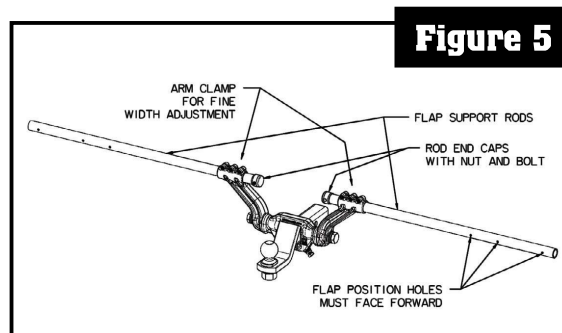

7. Slide FLAP CLAMPS over the FLAP SUPPORT RODS with square holes facing away from vehicle. Do not secure with FLAP RETAINER BOLTS yet. (See Figure 6 for orientation of flap retainer bolt hole and flap support rod positioning holes.) (Note: MUDFLAP not yet attached.) *Figure 6.*

Figure 6

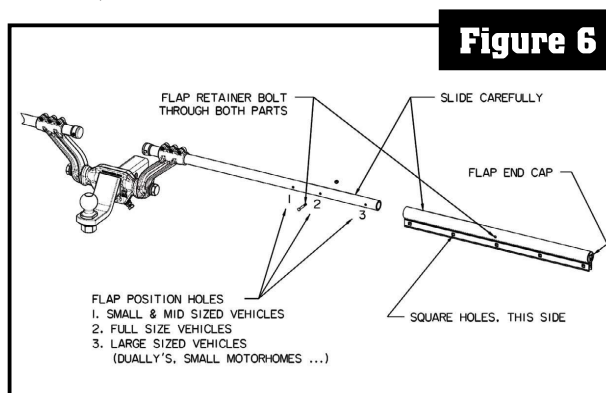

6

IMPORTANT: This next step is critical in ensuring that the MUDFLAP SYSTEM is properly installed. All measurements should be made while tow vehicle has full tongue weight.

8. Make sure SUPPORT RODS are level on both sides and measure the distance from the bottom of FLAP SUPPORT ROD to the ground. Subtract the desired **ground clearance (3"- 4" recommended or 75 mm – 100 mm)**. **Figure 7.**

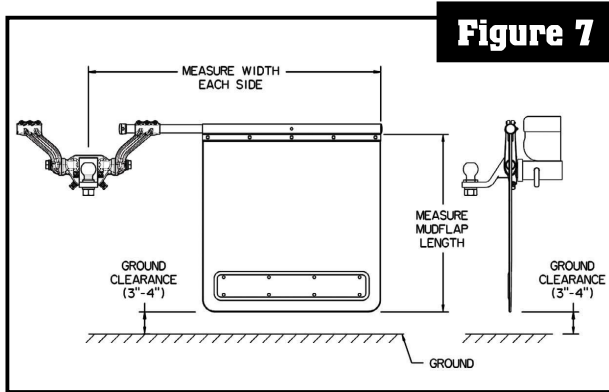

9. Lay MUDFLAP down with grooved side up on flat surface. Measure desired MUDFLAP length from the bottom up. Find the nearest pre-molded CUT LINE GROOVE and mark. **Figure 8.**

IMPORTANT: Before cutting and drilling/punching holes, make sure to place either a scrap piece of wood or thick cardboard underneath MUDFLAP to avoid any surface damage.

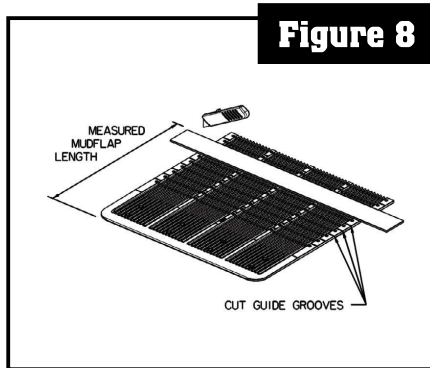

10. Use a sharp utility knife to cut through MUDFLAP using the groove and a straight edge as a guide. This may take several passes to completely cut through MUDFLAP. **See Figure 8.**

Repeat procedure for 2nd MUDFLAP.

IMPORTANT: Place a scrap piece of wood under the MUD FLAPS when punching or drilling holes, as the punch will dull and may damage the surface underneath.

11. Punch the top row of pre-molded holes in the MUDFLAP using the included BOLT HOLE PUNCH. **Figure 9.**

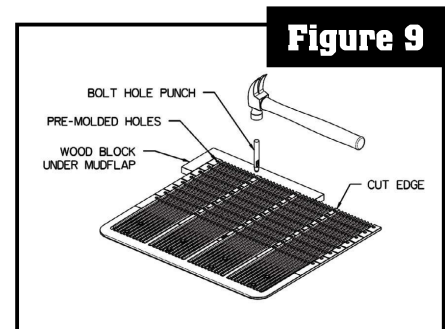

12. Assemble cut end of MUDFLAP into FLAP CLAMP by either sliding or pushing it down onto top of MUDFLAP with the square holes on the smooth side.

Note: Should it be difficult to slide MUDFLAP into FLAP CLAMP, moisten the cut end of MUDFLAP surface before inserting.

Insert the five M8 FLAP CLAMP BOLTS through the square holes. Loosely attach the M8 FLAT WASHER and M8 NYLON INSERT HEX NUT to the back as shown. (Do not tighten yet.) **Figure 10.**

Repeat for 2nd MUDFLAP.

13. Slide the FLAP CLAMP with attached MUDFLAP over the FLAP SUPPORT ROD with the NYLON INSERT HEX NUTS facing your vehicle.

Position the MUDFLAPS and FLAP SUPPORT RODS (left and right) as desired for your vehicle. Line up small hole in FLAP CLAMP with one of the three flap adjustment holes in SUPPORT ROD depending on vehicle size.

- Inner Hole - for small and mid-sized vehicles
- Center Hole - for full-size vehicles
- Outer Hole - for large vehicles, such as dually trucks and small motor homes

Finally, insert the small M5 FLAP RETAINER BOLT through FLAP CLAMP and SUPPORT ROD and attach the M5 NYLON INSERT HEX NUT. **Figures 1 & 6.**

Repeat for 2nd MUDFLAP.

14. Assemble TRIM PLATES. Insert M6 TRIM PLATE SPACERS into holes in raised bottom portion of MUDFLAP. Attach the ROCK TAMPERS TRIM PLATE with the eight M6 TRIM PLATE BOLTS (Locking STAR PIN™ [STAR PIN™ wrench included]), M6 FLAT WASHERS, and M6 NYLON INSERT HEX NUTS as shown in **Figure 10.** (20 in-lbs torque [10 mm socket or wrench]).

Repeat for 2nd MUDFLAP.

Note: DO NOT over tighten, as it will damage the TRIM PLATE.

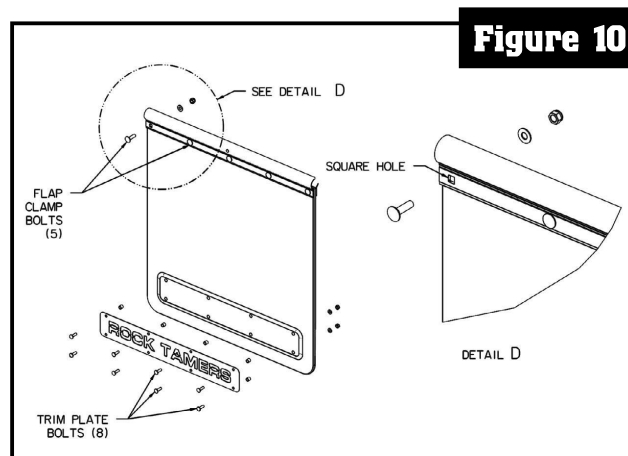

15. The ARMS of the HUB ASSEMBLY may be loosened and rotated to fit your vehicle application. The FLAP SUPPORT RODS must also be rotated slightly so the MUDFLAPS hang vertical.

Figure 11.

